



Prefab Kitchen Units



Contents

- 01 Product Introduction
- 02 Solution
- 03 High-tech Materials
- 04 Model Option
- 05 Technical Points
- 06 Projects

01

Product Introduction



Prefab Kitchen Units



- New high-tech materials
- Assembled by walls, floor, ceiling, cabinet, table, electricity
- Dry construction
- Maximize storage space utilization



① IW integrated wall system
③ IC integrated ceiling system

② IF integrated floor system
④ Cabinet storage system

02

Solution



- IW integrated wall system
- IF integrated floor system
- IS double ceiling
- Cabinet

IW integrated wall system



Solution

科逸|COZY



Wall elastic line



Ground bounce line



Surface layer

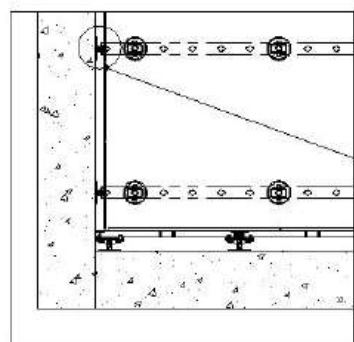

Wall bracket profile

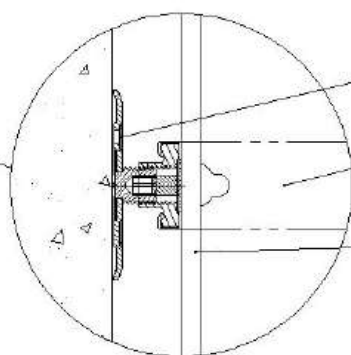

Wall overhead bracket

Wall profile

Wall finish 1. Ordinary tiles;
2. Ceramic sheet;
3. Coshock board.

- Technological innovation
- Efficient delivery rate
- Productive forces

- ◆ Comes with 25-44mm adjustable wall dragon skeleton hollow design;
- ◆ No slotting is required, line pipes and water pipes are directly installed on the overhead layer;
- ◆ All-dry assembly construction



Solution_IW integrated wall system

科逸 | COZY

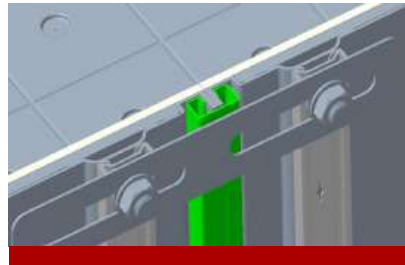
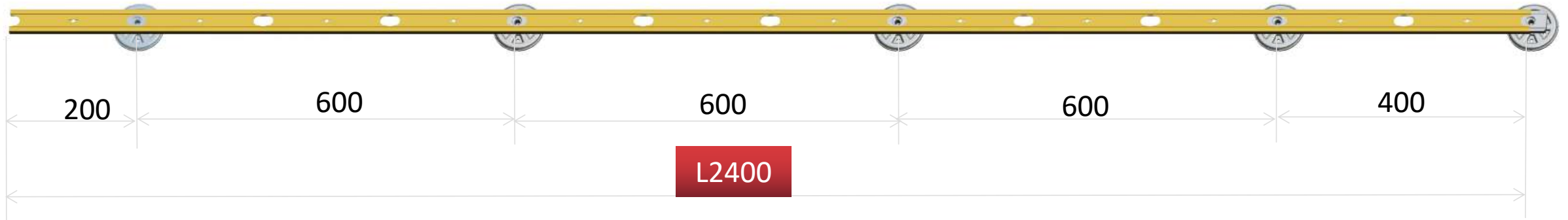

Center joint



External corner
installation node



Internal corner
installation node



Effect of wall
panel installation

- ◆The largest single ceramic tile size can reach 600*1200MM
- ◆The whole PHC ceramic sheet can be made up to 800*2400, and the total weight does not exceed 28 kg
- ◆Fire resistance, impact resistance, scratch resistance, moisture and water resistance, no formaldehyde, no vocs emission.
- ◆Factory precise prefabrication, all-dry construction
- ◆Easy to clean and clean, resistant to oil stains



Effect picture_IW integrated wall system

科逸 | COZY



IF integrated floor system



- Technological innovation
- Efficient delivery rate
- Productive forces

Solution

科逸 | COZY

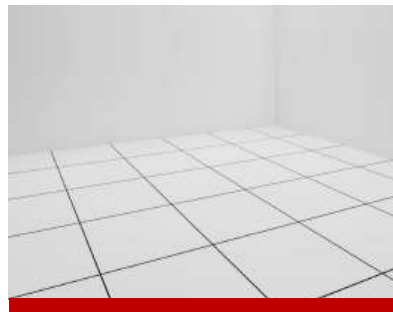

Ground bounce line



Surface layer paving
(without floor heating)

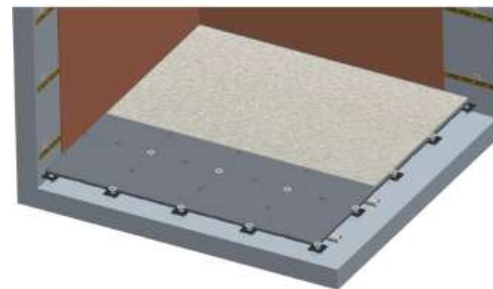

adjustment base +
cement board



Surface layer paving
(with floor heating)

- ◆ With 42-113mm (excluding floor heating and surface finish), 72-143mm (including underfloor heating, without surface finish) adjustable floor bracket overhead design;
- ◆ Aluminum foil composite protective layer floor heating module;
- ◆ High pressure cement built-in steel wire fiber board base layer, bearing 300KG/m²



Effect picture_IF integrated floor system

科逸|COZY

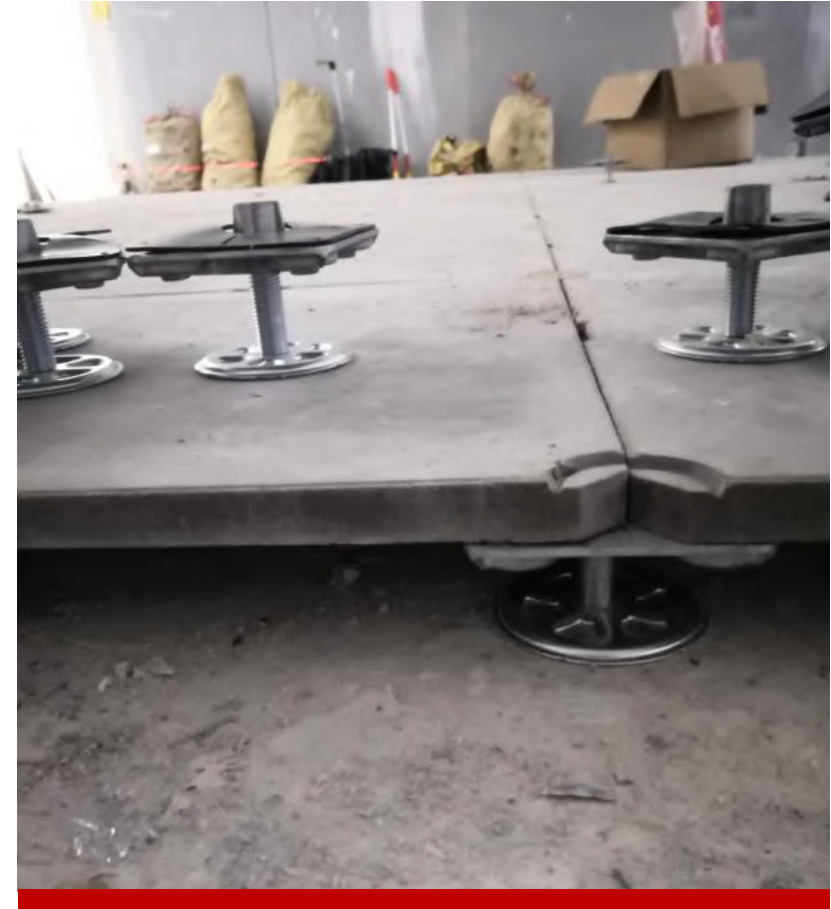

Solution

IS double ceiling

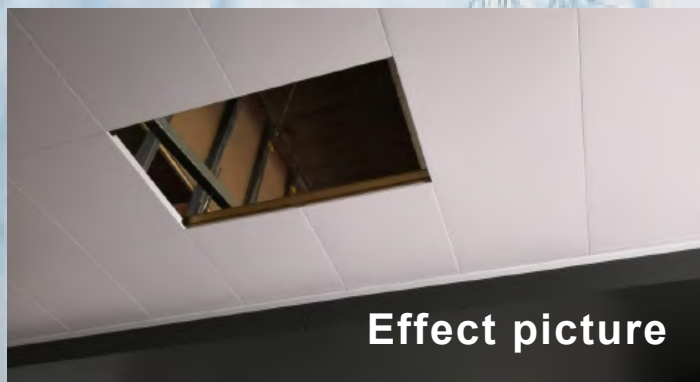

Effect picture

- Technological innovation
- Efficient delivery rate
- Productive forces

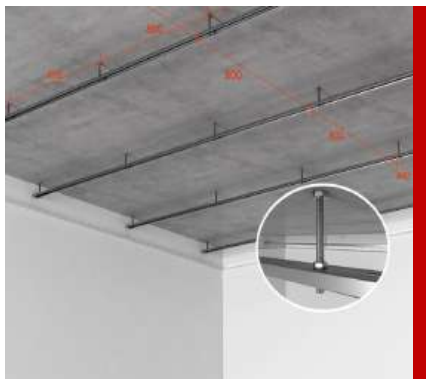

Ground bounce line



Install the triangular profile



Ann decorative panel aluminum gusset



Ann decorative panel SMC gusset

- ◆ Polymer nanotechnology to create environmentally friendly ceiling materials
- ◆ Multiple choices of SMC integrally molded new gusset material
- ◆ The minimum ceiling height is 5CM, which is about 50% less than the traditional ceiling height



Solution

科逸 | COZY

Cupboard



- Technological innovation
- Efficient delivery rate
- Productive forces



SMC cupboard is waterproof, corrosion-resistant, wear-resistant, easy to clean



Ergonomics, expand storage space, flexible storage

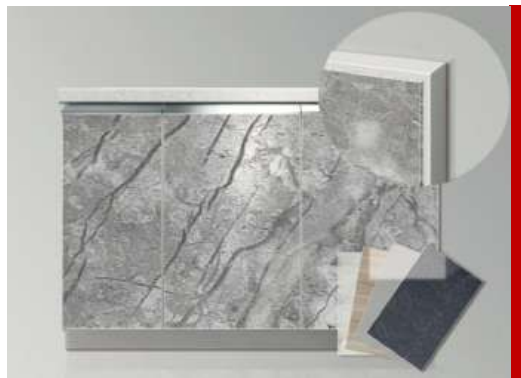

SMC fully cladding door panel to ensure the portability of stone door panel



The hinge design of the door panel is not easy to sag



SMC Cupboard

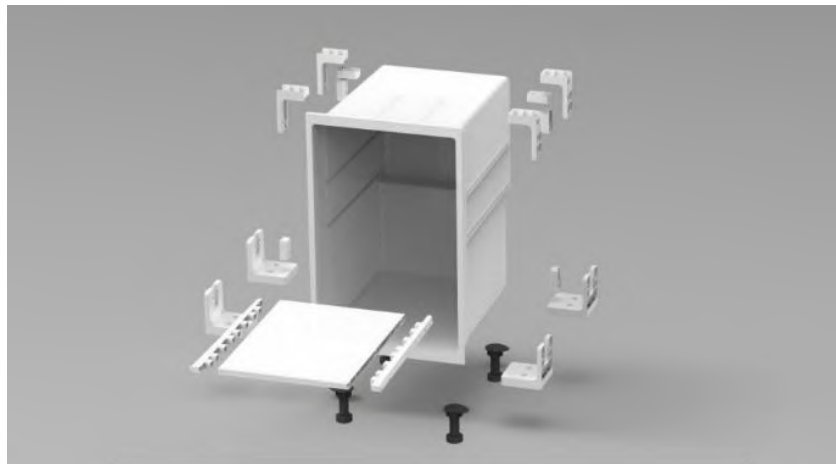

科逸 | COZY

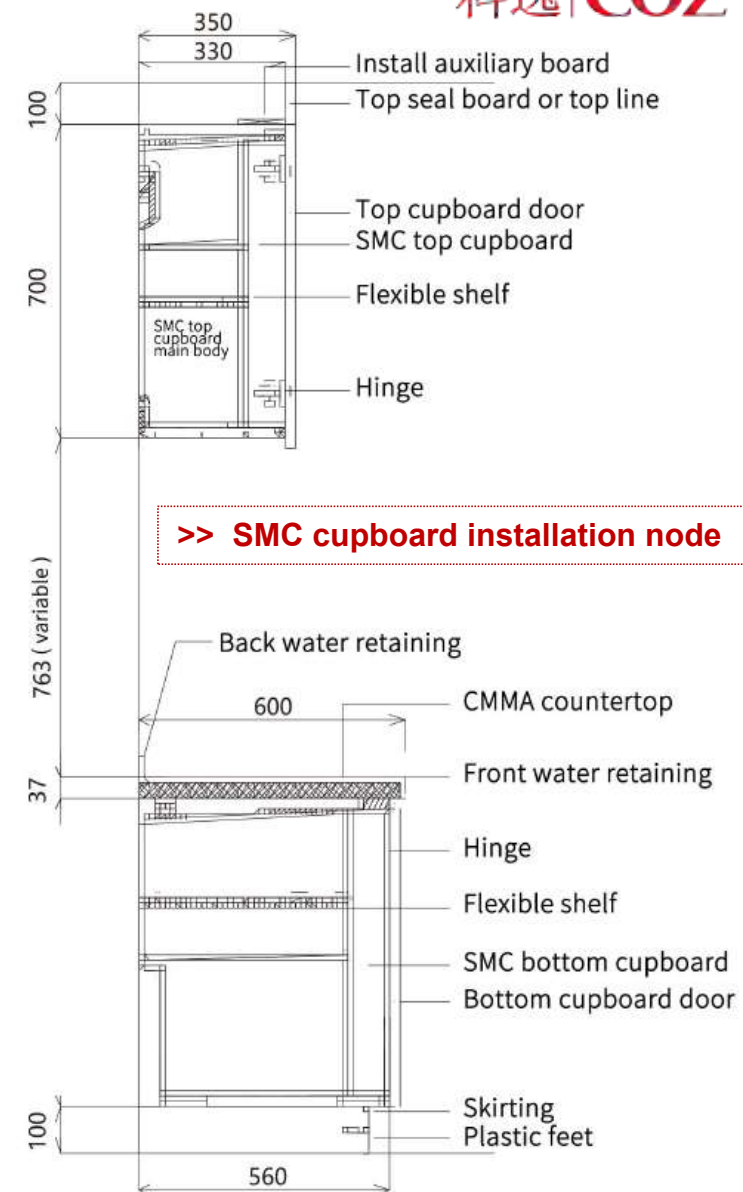



Effect picture_Top cupboard

科逸|COZY





Effect picture_Bottom cupboard

科逸|COZY





Storage function_Cupboard

科逸|COZY

Sink down storage box



Tool integrated storage box



Flip storage box



Drawer divider system



Catering table



Storage box



Multifunctional trash can





Storage function_Cupboard

科逸|COZY

Double cutlery box



Multi-layer flying saucer



Door hanging basket



Corner storage cabinet



Power rail system



Adjustable storage rack for sink



Sink cube (cutting board/drain board)



03 High-tech Materials



- Soft quartz stone veneer
- Ceramic sheet veneer
- SMC material
- CMMA material
- Aluminum gusset



High-tech materials

科逸|COZY

Wall & Floor & Countertop_ Soft quartz stone veneer



- The thickness is only 6/8/11mm
- The surface structure is tight and impermeable
- Waterproof and fireproof
- Wear-resistant and corrosion-resistant





High-tech materials

Wall & Floor & Mesa_ Ceramic sheet veneer



- Green, low-carbon, weather-resistant and durable
- Facing boards, industrial upgrading
- Saving source and reducing consumption, thin and light weight
- Save labor and effort, and save total cost



High-tech materials

Ceiling & Cupboard_ SMC material



- Anti-mould and moisture-proof
- Scratch and abrasion resistance
- Green and safe
- Stable and sturdy



● High-tech materials

Mesa_CMMA material



- Resistance to penetration
- No radioactive contamination
- Lightweight and impact resistant
- Stain resistant and easy to clean

科逸 | COZY



● High-tech materials

Ceiling_Aluminum gusset ➔

- Green, low-carbon, weather-resistant and durable
- Facing boards, industrial upgrading
- Saving source and reducing consumption, thin and light weight
- Save labor and effort, and save total cost



04

Model Option

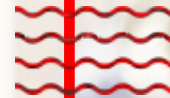



Model Option

科逸|COZY



[Lake]



[Fashion]



Model Option

科逸 | COZY



[Simplicity]

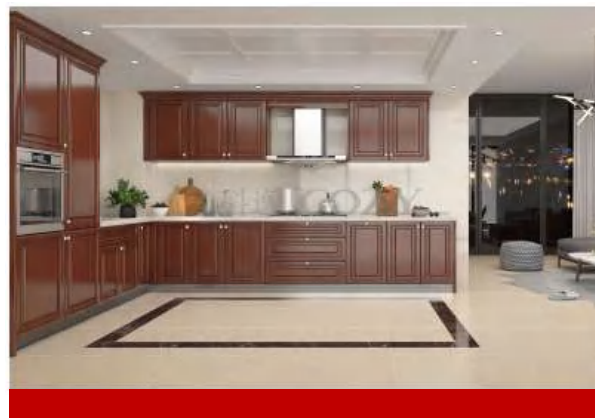

[Time]



[Dream]

Model Option

科逸 | COZY



[Quiet]



[Town]

05 Technical Points

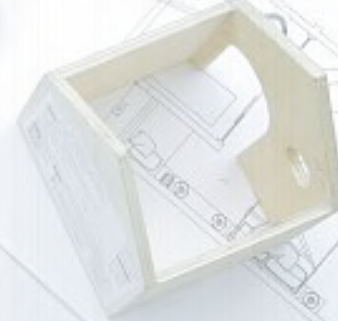



Technical Points

科逸 | COZY

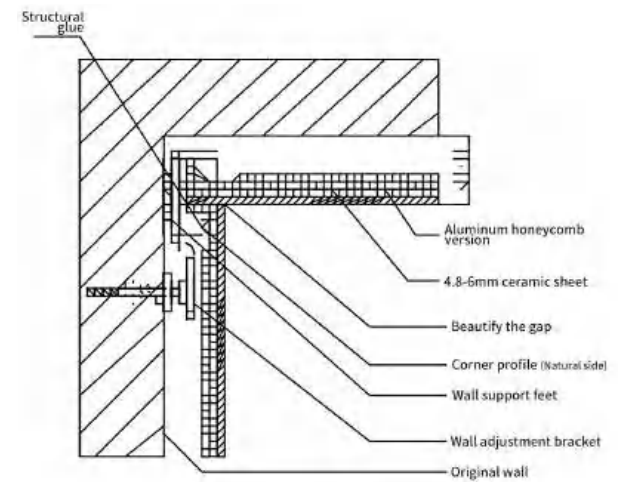
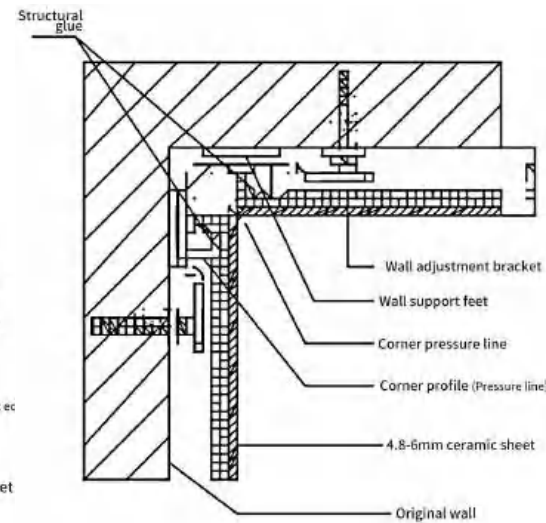
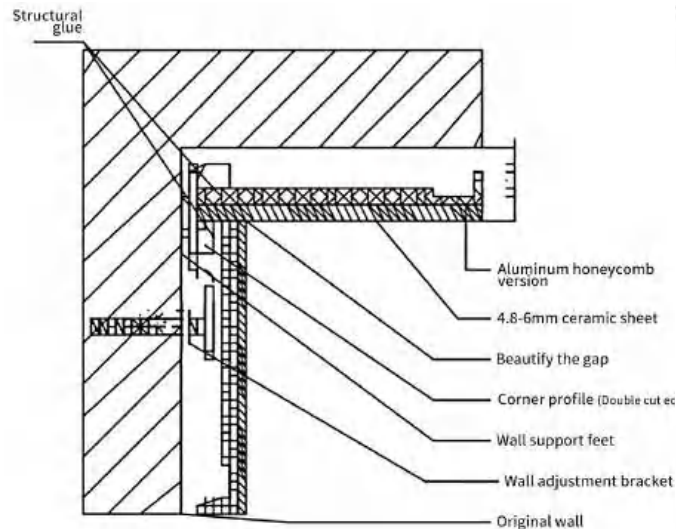
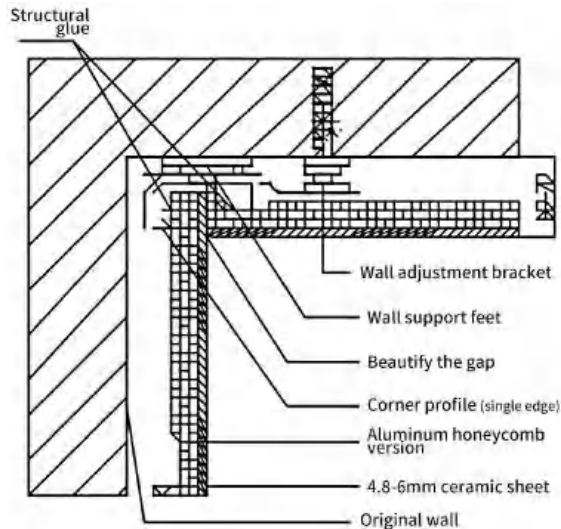
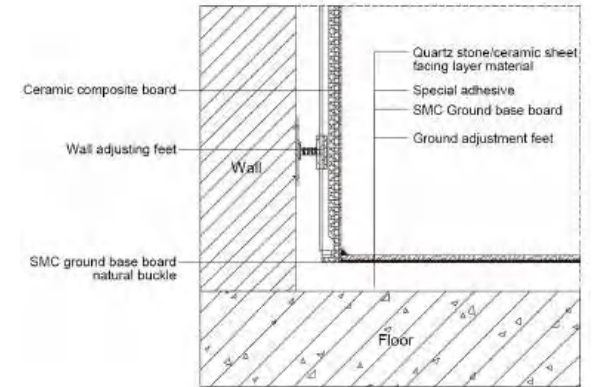
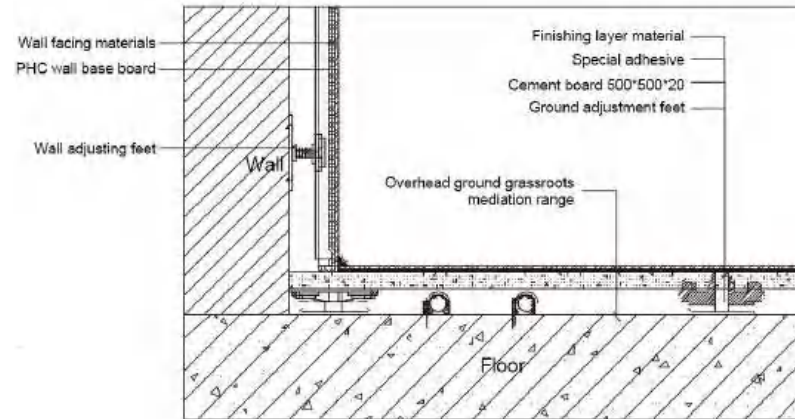
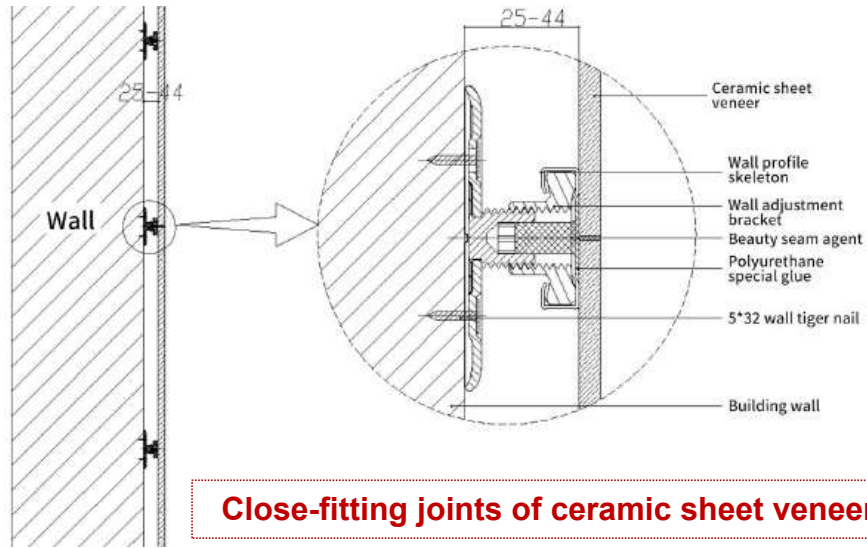



Technical Points

科逸 | COZY

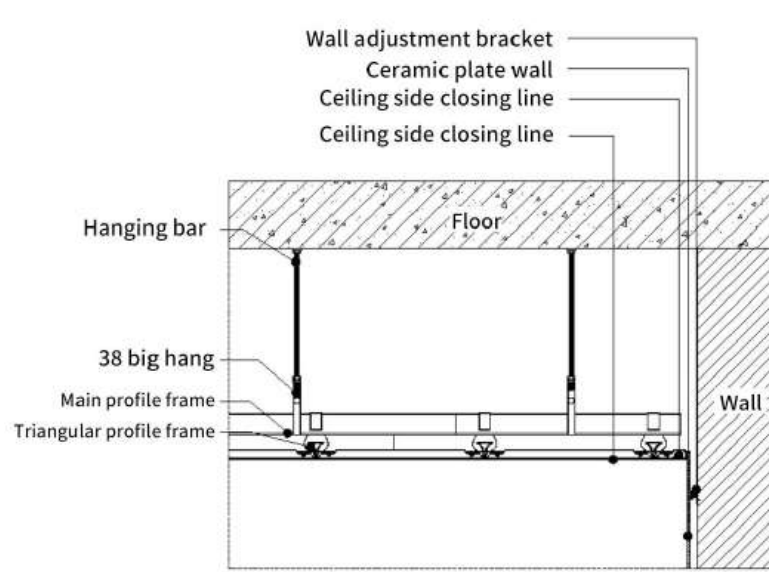

Node at the junction of ceiling and wall

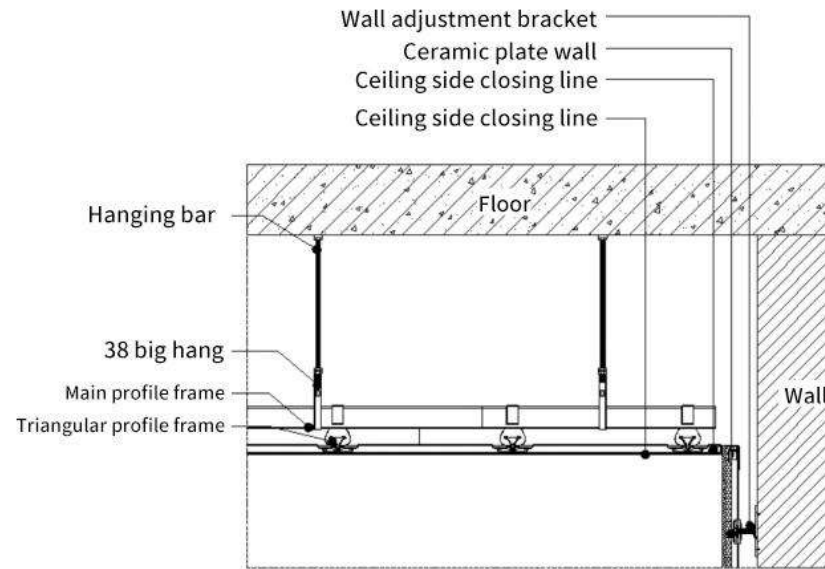

PHC wall profile node -center seam (beautify the gap)

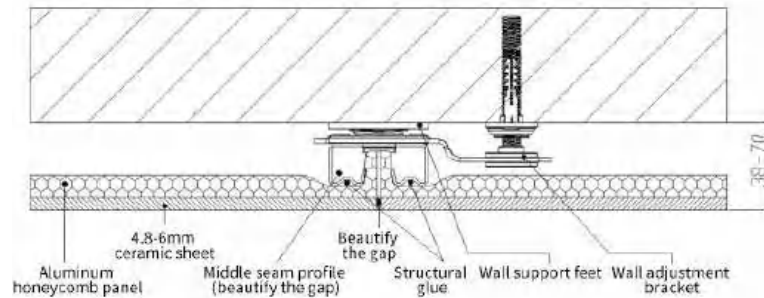

PHC wall profile node -center seam (beautify the gap)

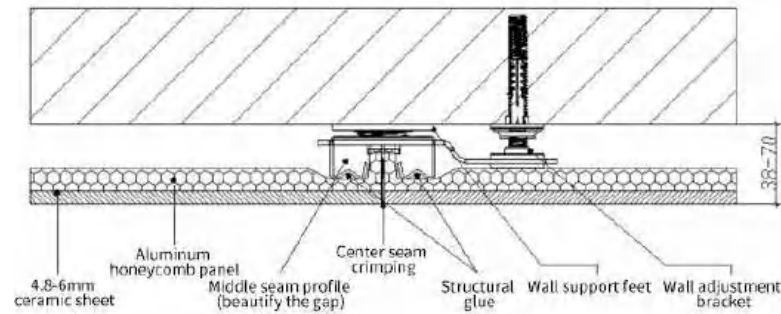

PHC wall profile node -center seam (press line)

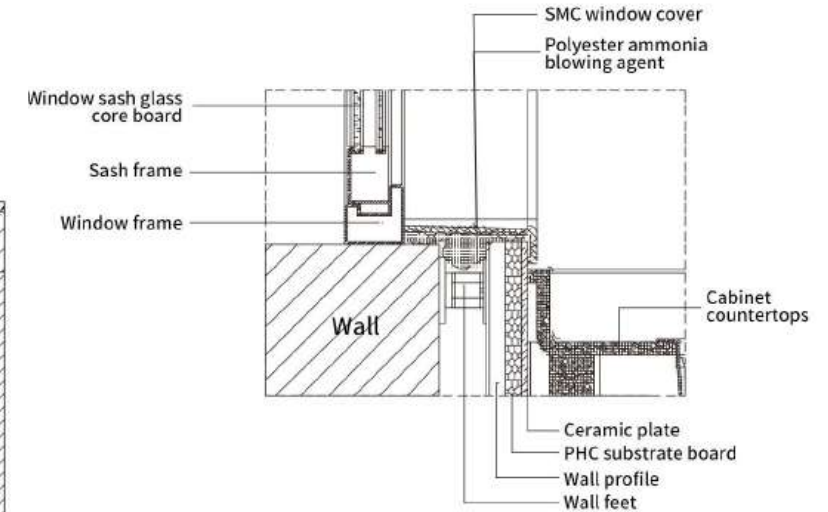

SMC window cover installation node

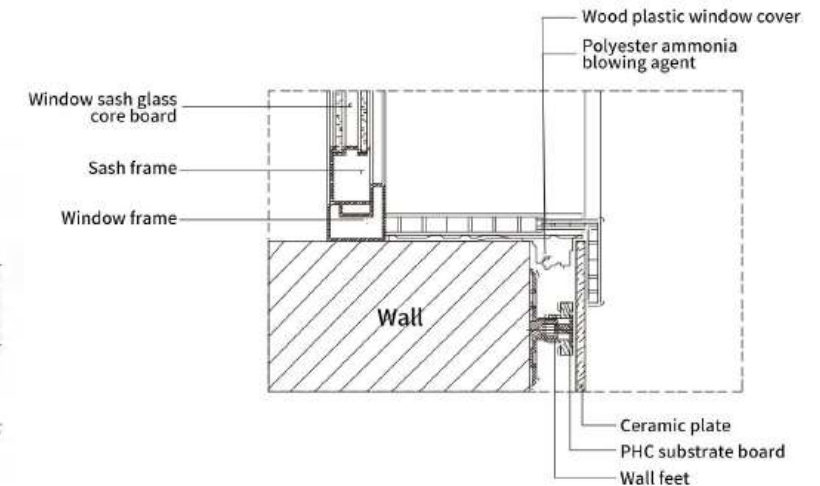

Wood plastic window cover installation node



Technical Points

科逸 | COZY

Bracket and wall connection method

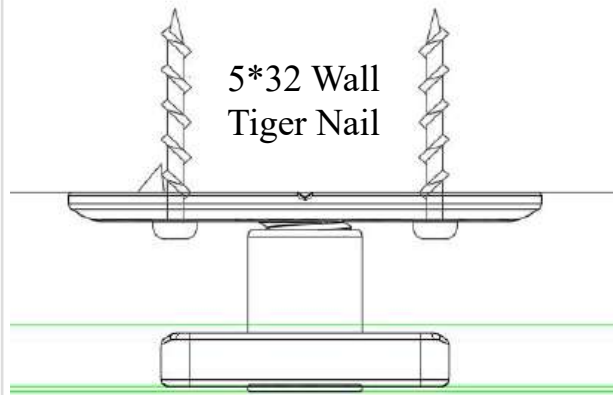

No need for expansion sleeve

1. Punch the wall with a $\phi 5$ impact drill bit;
2. Use an electric drill to fix the wall tiger nail into the punched hole.

Distribution map of the frame of the wall bracket profile of the hall

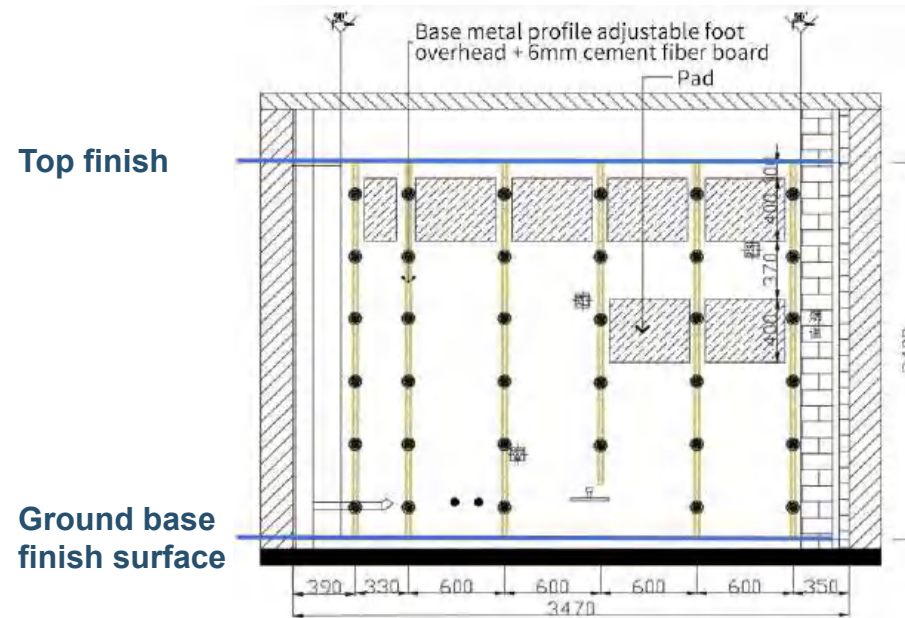

External corner installation node of ceramic sheet veneer

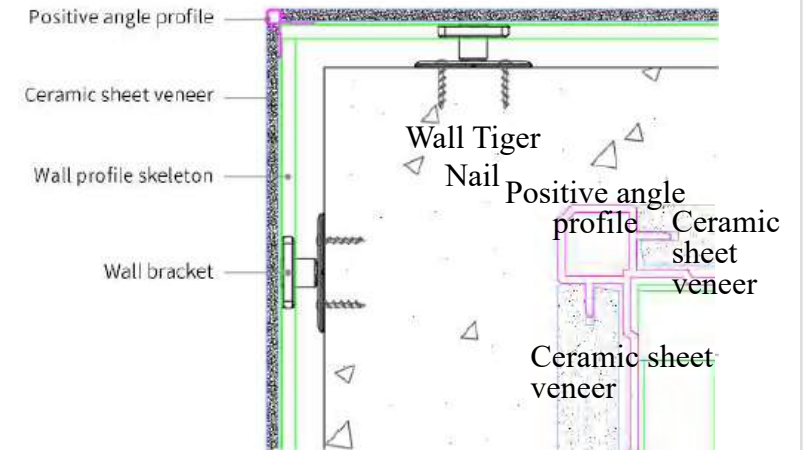

06 Projects



- Longfor
- Vanke
- Dalian Yida Group
- BUCG

Projects

Domestic projects

- Longfor
- Vanke
- Dalian Yida Group
- BUCG

vanke 万科

Longfor 龙湖地产

YIDA 亿达

北京城建集团
BEIJING URBAN CONSTRUCTION GROUP CO., LTD.



科逸 | COZY



Projects

Domestic projects

- Longfor
- **Vanke**
- Dalian Yida Group
- BUCG

vanke 万科

Longfor 龙湖地产

YIDA 亿达

北京城建集团
BEIJING URBAN CONSTRUCTION GROUP CO., LTD.



科逸 | COZY



Projects

Domestic projects

- Longfor
- Vanke
- **Dalian Yida Group**
- BUCG

vanke 万科

Longfor 龙湖地产

YIDA 亿达

 北京城建集团
BEIJING CITY CONSTRUCTION GROUP CO., LTD.

科逸 | COZY



Domestic projects

- Longfor
- Vanke
- Dalian Yida Group
- **BUCG**

vanke 万科

Longfor 龙湖地产

YIDA 亿达

北京城建集团
BEIJING URBAN CONSTRUCTION GROUP CO., LTD.



A photograph showing two men shaking hands. The man on the left is wearing a dark grey suit, and the man on the right is wearing a light grey work jacket. They are standing in front of a blurred industrial background with yellow and black safety railings. A thick red curved line separates the image from the text below.

Thank You!

Thank you for your attention, and look forward to cooperating with you.

2021